

OXHEAD TAVERN

Room Locator

BEACH

LAKE FRONT

PADDLE BOATS

GAZEBO

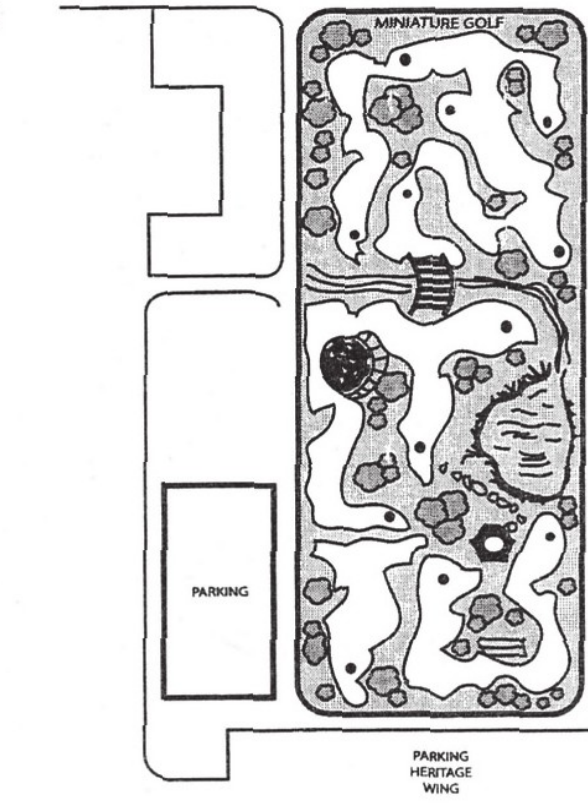
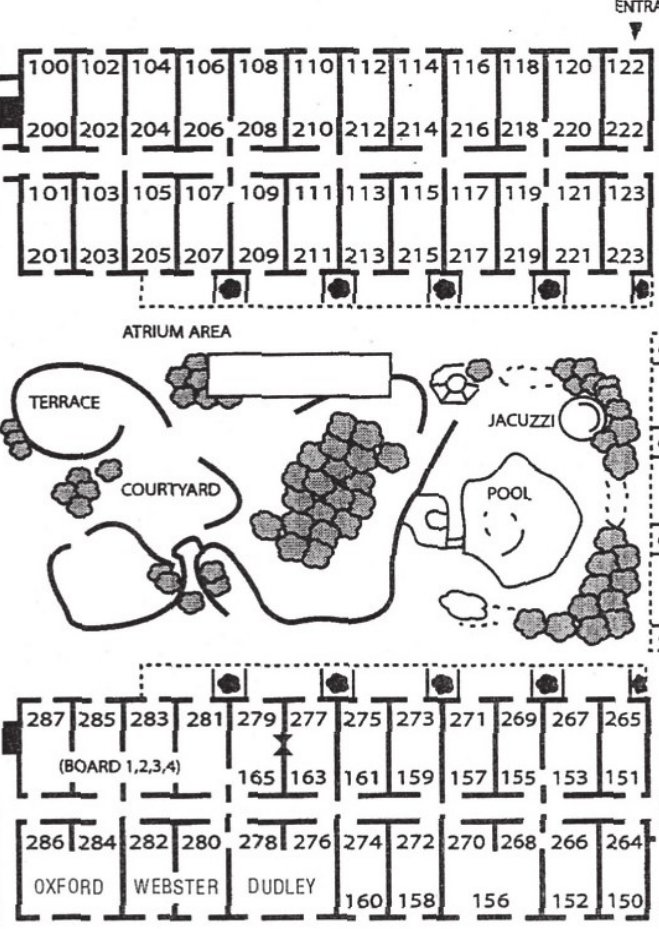
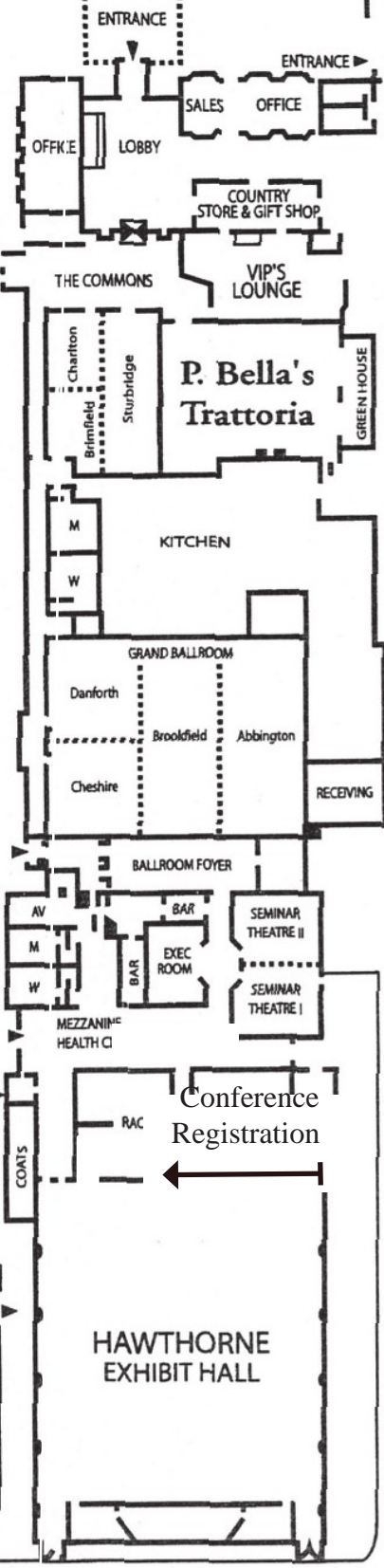

Important Information about our NEW MEETING Place

**The conference site for the 42nd Northeast Regional Conference
on the Social Studies is the Sturbridge Host Hotel and Conference Center,
366 Main Street, Sturbridge, MA 508-347-7393**

Diagrams of room layouts are found inside the back cover.

GETTING TO THE CONFERENCE SITE

Driving Directions : Sturbridge Host Hotel & Conference Center is located on Route 20. From the North, East and West, take the Massachusetts Turnpike (Interstate 90) to Exit 9, Route 20 West. From the South, take either Interstate 84 or Route 131 to Route 20 West. Sturbridge Host Hotel & Conference Center is located on the shore of Cedar Lake, just past the first set of traffic lights.

Airport & t rAnspOrtAtion . Sturbridge Host Hotel & Conference Center is conveniently located near Logan International Airport in Boston (62 miles), Bradley International Airport near Hartford, Connecticut (50 miles), and TF Green Airport near Providence, Rhode Island (60 miles). Worcester Regional Airport is approximately 30 miles from the hotel.

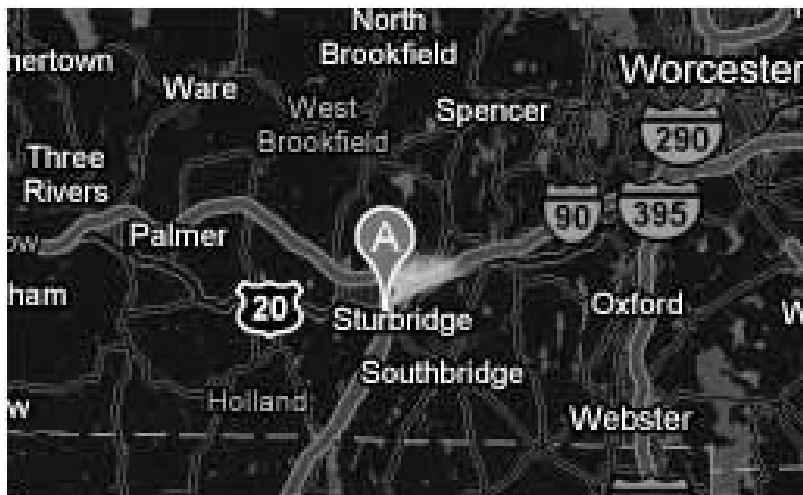

HOTEL RESERVATIONS—Sleeping room reservations may be made by completing and returning the room reservation form on page 12. **RETURN IT DIRECTLY TO THE STURBRIDGE HOST HOTEL BY April 1, 2011.** This insures the special room rate.

PARKING—Parking at the hotel is free.

PACKAGE DELIVERY— The hotel will not accept shipment of goods or materials more than 48 hours in advance of client's arrival. Hotel will apply a storage fee for all property stored at the hotel for more than 48 hours, fee not to exceed \$5.00 per parcel. Client acknowledges and agrees that arrangements by hotel for receipt and storage of any shipment is done solely as an accommodation and convenience to client. The hotel is not an insurer of client's property, and any such arrangements do not create a bailment either express or implied. All risk for any loss, theft, damage or destruction to any personal property shipped to or stored at the hotel is borne by the client. Packages should be addressed to the person who will be receiving them, show date and name of event and indicate, in the case of multiple boxes, Box 1 of 5, Box 2 of 5, etc.